

DEMS 440-B03 / 450-B03

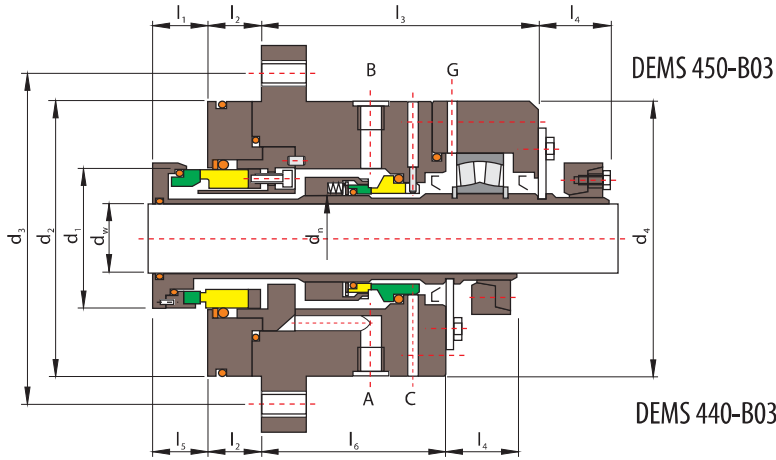

Çalışma Limitleri

Basınç: $\leq 1.4\text{MPa}/\leq 2.3\text{MPa}$
 Hız: $\leq 10\text{m/s}/\leq 20\text{m/s}$
 Sıcaklık: $-30^\circ\text{C}\sim+200^\circ\text{C}/-20^\circ\text{C}\sim+300^\circ\text{C}$

Operating Limits

Pressure: $\leq 1.4\text{MPa}/\leq 2.3\text{MPa}$
 Speed: $\leq 10\text{m/s}/\leq 20\text{m/s}$
 Temperature: $-30^\circ\text{C}\sim+200^\circ\text{C}/-20^\circ\text{C}\sim+300^\circ\text{C}$

- Döner Yüzey (SiC/Carbon/TC)
- Sabit Eleman (SiC/Ceramic/TC)
- Elastomer (VITON/Encapsulated Ring/KALREZ)
- Diğer Parçalar (SUS304/SUS316/Titanium/Hastelloy-C)
- Rotary Ring(SiC/Carbon/TC)
- Stationary Ring(SiC/Ceramic/TC)
- Secondary Seal(VITON/Encapsulated Ring/KALREZ)
- Other Parts (SUS304/SUS316/Titanium/Hastelloy-C)

dn (mm)	dw	d ₁	d ₂	d ₃	d ₄	l ₁	l ₂	l ₃	l ₄	l ₅	l ₆	A,B	C
30	20	52	117	140	118	35	30	114	30	22	75	G3/8	G1/8
35	25	58	124	150	128	35	30	127	30	22	85	G3/8	G1/8
40	30	62	134	165	138	35	30	129	30	24	87	G3/8	G1/8
45	35	68	140	175	148	35	30	130	30	24	87	G3/8	G1/8
50	40	75	145	175	148	35	30	133	34	26	90	G3/8	G1/8
55	45	82.7	150	175	148	35	30	135	34	26	90	G3/8	G1/8
60	50	85	160	185	158	41	30	150	34	30	105	G3/8	G1/8
65	50	90	170	195	168	41	30	160	34	30	105	G3/8	G1/8
70	55	95	175	205	178	41	30	160	34	30	105	G3/8	G1/8
75	60	100	180	205	178	41	30	160	34	30	105	G3/8	G1/8
80	65	110	190	220	188	41	40	190	44	30	105	G3/8	G1/8
85	70	115	195	230	198	41	40	190	44	30	105	G3/8	G1/8
90	75	120	200	230	198	41	40	190	44	30	105	G3/8	G1/8
95	80	127	205	235	203	41	40	190	44	30	105	G3/8	G1/8
100	80	130	210	240	208	41	40	190	44	30	105	G3/8	G1/8
105	85	135	215	250	218	41	40	190	44	30	105	G1/2	G1/4
110	90	140	230	260	228	41	40	190	44	31	110	G1/2	G1/4
115	95	145	235	270	238	41	40	190	44	31	110	G1/2	G1/4
120	100	150	240	270	238	42	40	200	50	31	120	G1/2	G1/4
130	110	160	255	290	258	42	40	200	50	31	120	G1/2	G1/4
140	120	172	265	305	268	43	50	220	50	41	130	G1/2	G1/4
150	130	185	275	315	278	43	50	220	50	41	130	G1/2	G1/4
160	140	195	290	335	298	43	50	220	50	41	130	G1/2	G1/4
170	150	205	300	335	323	47	50	220	50	45	130	G1/2	G1/4
180	160	220	330	355	358	47	50	250	50	45	140	G1/2	G1/4
190	170	230	345	375	358	47	50	250	55	45	140	G1/2	G1/4
200	180	240	365	395	378	47	50	250	55	45	140	G1/2	G1/4
210	190	260	385	415	378	50	50	250	55	45	140	G1/2	G1/4
220	190	270	395	425	388	50	50	250	55	45	140	G1/2	G1/4
230	200	280	395	425	388	50	50	300	55	45	160	G1/2	G1/4